



## Applications

Ensures proper connection between Slotted Channel and supporting substrate member of building

## Advantages

U shaped welded on Base Plate profile holds Strut Channel in position & allows easy fixing to base concrete of building

Designed Strut Base fitting can be used to carry medium to heavy load installation applications

## Properties

**Standards**  
EN 10025

**Material**  
Steel

**Finish**  
Electro Zinc Plated GI /  
Hot dip galvanized HDG /  
Stainless Steel A4

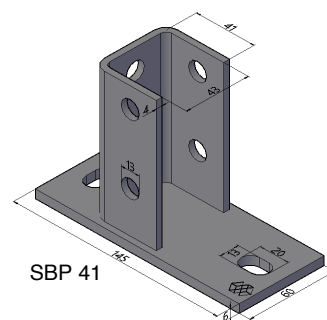
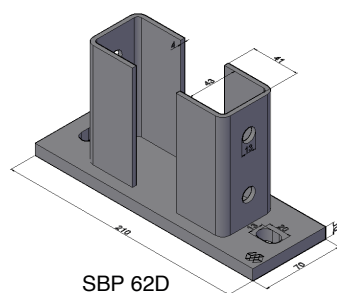
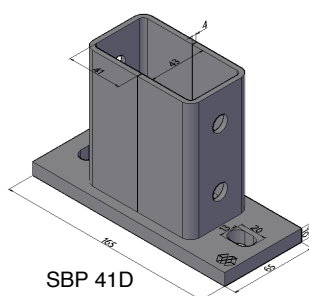
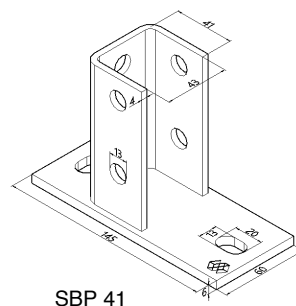
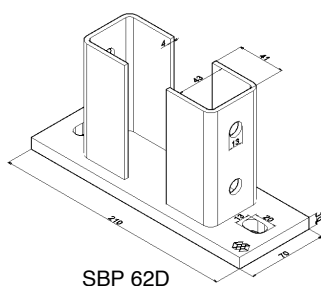
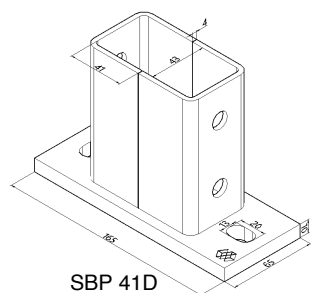

## Technical Data

### Hot Dip Galvanized Base Plates

Item	Art number	For Channel Sizes (mm)	Sales Unit (Pcs)
SBP 41 - HDG	48004	21, 41, 21D, 62	10
SBP 41D - HDG	48005	41D	5
SBP 62D - HDG	48006	62D	5

**Note:**

Other Finishes are available upon request